

# Test Point Terminals with Accu-Lok™ or Press-Fit Mounting

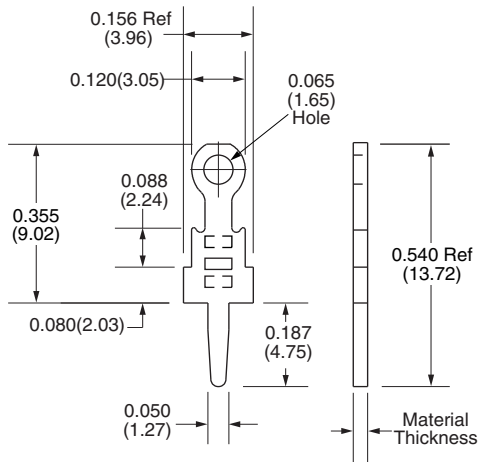

<b>Loose Part No.</b>	1032	1033
<b>Reeled Part No.</b>	6032	6033
<b>Mounting Type</b>	Press-Fit	Press-Fit
<b>Material Thickness/Type</b>	0.020" (0.51mm) Brass	0.032" (0.81mm) Brass
<b>Standard Finish</b>	Loose: 100% Tin over Copper Reeled: 100% Tin over Copper	
<b>Mounting Hole Diameter</b>	0.046" ±0.003" (1.17mm ±0.076mm)	0.050" ±0.003" (1.27mm ±0.076mm)
<b>Applicator System</b>	Loose: ZPT81-TP Reeled: Model 9700, 9700 XY	

For exact finish specifications and available special finishes, see Finish Table (page 106).

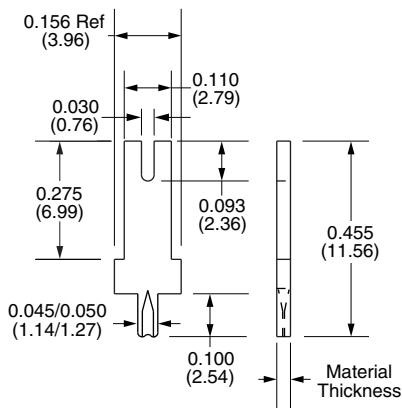

<b>Loose Part No.</b>	1050-030	1049-030
<b>Reeled Part No.</b>	6050-030	6049-030
<b>Mounting Type</b>	Accu-Lok™ Splay	Accu-Lok™ Splay
<b>Material Thickness/Type</b>	0.020" (0.51mm) Brass	0.032" (0.81mm) Brass
<b>Standard Finish</b>	Loose: 100% Tin over Copper Reeled: 100% Tin over Copper	
<b>Mounting Hole Diameter</b>	0.050" ±0.003" (1.27mm ±0.076mm)	0.054" ±0.003" (1.37mm ±0.076mm)
<b>Applicator System</b>	Loose: ZPT81-TP Reeled: Model 7000, 9700, 9700 XY	

U.S. Patent(s) No. 5,017,159 and 5,082,460.

For exact finish specifications and available special finishes, see Finish Table (page 106).